



A Tyco Electronics USA Joint Venture

Technical Data Sheet

For

RSA: cable gland



(A TE Connectivity - RPG Enterprises JV)



Raw Material Specification RSA Cable Gland:

Raychem RPG Manufacturers RSA double compression Cable Gland as per the requirement of **BS 6121-1:2005; & IEC/EN 62444 (Harmonized std. for European low voltage directive 2014/35/EU)**.

Technical Data:

Design specification	: IEC 62444
Electrical Category	: Category B
Mechanical Category	: Impact Category 8 (IK 10),
Level of ingress protection	: IP66 (EN 60529)
Cable type	: Armoured (SWA - AWA)
Seal Operating temperature	: Neoprene -from -20°C to +130 °C Silicon -from -20°C to +200°C (Optional)
Material	: Brass, Stainless steel, Nickel plated brass, Aluminum
Thread Type	: Metric/NPT (Other thread types also available upon request: PG/ANS)

Exploded View Of RSA Cable gland:

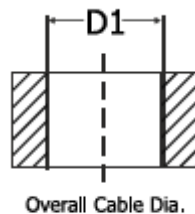

(B)

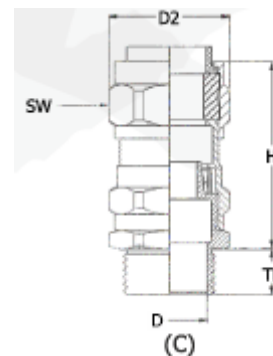

(C)

Item	Item Description
1	Entry nut.
2	Retainer ring blue
3	Compression washer
4	Main body
5	Sealing ring
6	Armour
7	Cone body
8	Cable

Product Code Table:

No. of Sealing	Size	Material				Sealing material		Code
		BR	NI	SS	Al	SI	N	
Single	Metric: MXXXX	Brass	Nickel Plated Brass	Stainless Steel	Aluminum	Silicon	Neoprene	RSAM20SBRN

Thread Type	RSA Cable gland code	Clamping Range (mm) Ø min-max (Dig.--b)	Cable gland dimension				
			D1 (mm)	H (mm)	TL (mm)	SW (mm)	D (mm)
M20x1.5	RSAM20S	6.1-13	42.5	10	24	26.5	26.5
M20x1.5	RSAM20M	9.5-15.8	42.5	10	24	26.5	26.5
M20x1.5	RSAM20L	12.5-20	42.5	10	30	33	33
M25x1.5	RSAM25S	14-21.9	52	10	38	41.5	41.5
M25x1.5	RSAM25L	18.3-25.2	56	10	38	41.5	41.5
M32x1.5	RSAM32L	23.8-33	56	10	46	50.5	50.5
M40x1.5	RSAM40L	28.0-40	58.5	15	55	60	60
M50x1.5	RSAM50S	35.2-46	58.5	15	60	66	66
M50x1.5	RSAM50L	40.5-52.5	60	15	70	75	70
M63x1.5	RSAM63S	45.7-59	65	15	75	82	82
M63x1.5	RSAM63L	54.7-65	65	15	80	86	86
M75x1.5	RSAM75S	59-71.5	73	15	90	98	98
M75x1.5	RSAM75L	66.8-78	78	15	98	106	106
M90x1.5	RSAM90L	76.2-90	98	24	114	125	125
M100x1.5	RSAM100L	76-90	140	24	123	135	135



A Tyco Electronics USA Joint Venture

Technical Data Sheet

For

RDA: Double seal cable glands



(A TE Connectivity - RPG Enterprises JV)



Raw Material Specification RDA Cable Gland:

Raychem RPG Manufacturers RDA double compression Cable Gland as per the requirement of **BS 6121-1:2005; & IEC/EN 62444 (Harmonized std. for European low voltage directive 2014/35/EU)**.

Technical Data:

Design specification	: IEC 62444
Electrical Category	: Category B
Mechanical Category	: Impact Category 8 (IK 10),
Level of ingress protection	: IP66 (EN 60529)
Cable type	: Armoured (SWA - AWA)
Seal Operating temperature	: Neoprene-from -20°C to +130 °C Silicon -from -20°C to +200°C (Optional)
Material	: Brass, Stainless steel, Nickel plated brass, Aluminum
Thread Type	: Metric/NPT (Other thread types also available upon request: PG/ANS)

Exploded View Of RDA Cable gland:

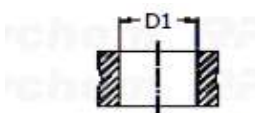
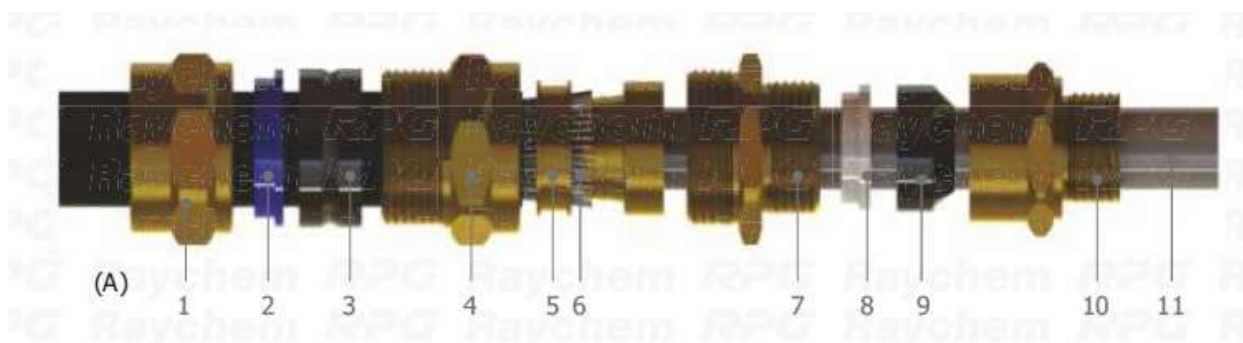

Overall Cable Dia.



Cable Bedding Dia.

(B)

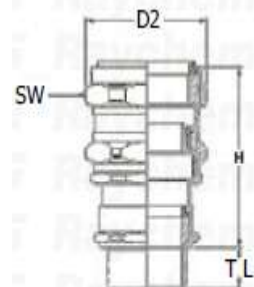

(C)

Item	Item Description
1	Entry nut.
2	Retainer ring blue
3	Compression washer
4	Main body
5	Sealing ring
6	Armour
7	Cone body
8	Retainer ring white
9	Displacement Washer
10	Body inner sheath
11	Cable

Product Code Table:

No. of Sealing	Size	Material				Sealing material		Code
		BR	NI	SS	Al	SI	N	
RDA	XXXXX	BR	NI	SS	Al	SI	N	
Double	Metric: MXXXX	Brass	Nickel Plated Brass	Stainless Steel	Aluminum	Silicon	Neoprene	RDAM20SBRN

Thread Type	RDA Cable gland code	Clamping Range (mm) Ø min-max (Dig.-1-b)		Cble gland dimension (Dig.3-C)				Armour Wirec dia (mm)
		D1 (mm)	D1 (mm)	H min (mm)	TL min (mm)	SW (mm)	D2 min (mm)	
M20x1.5	RDAM20S	3.1-8.5	6.1-13	64	10	24	26.5	0.7-1.2
M20x1.5	RDAM20M	6.1-11.7	9.5-15.8	64	10	24	26.5	0.7-1.2
M20x1.5	RDAM20L	6.5-14	12.5-20	66	10	30	33	0.7-1.2
M25x1.5	RDAM25S	11.0-20	14-21.9	80	10	38	41.5	1.25-1.6
M25x1.5	RDAM25L	17-26	18.3-25.2	80	10	38	41.5	1.25-1.6
M32x1.5	RDAM32L	22-32.2	23.8-33	84	10	46	50.5	1.6-2.0
M40x1.5	RDAM40L	29.5-38	28-40	85	15	55	60	1.6-2.0
M50x1.5	RDAM50S	35.5-44	35.2-46	85	15	60	66	2.0-2.5
M50x1.5	RDAM50L	40-50	40.5-52.5	90	15	70	70	2.0-2.5
M63x1.5	RDAM63S	47.5-55.8	45.7-59	90	15	75	82	2.0-2.5
M63x1.5	RDAM63L	53-62	54.7-65	95	15	80	86	2.0-2.5
M75x1.5	RDAM75S	59-64	59-71.5	100	15	90	98	2.0-2.5
M75x1.5	RDAM75L	66.5-78.5	66.8-78	108	15	98	106	2.5-3.0
M90x1.5	RDAM90L	76-90	76.2-90	140	24	114	125	3.15-4.0
M100x1.5	RDAM100L	76-90	86.5-101	140	24	123	135	3.15-4.0



A Tyco Electronics USA Joint Venture

Technical Data Sheet

For

RSA: cable gland



(A TE Connectivity - RPG Enterprises JV)



Raw Material Specification RSA Cable Gland:

Raychem RPG Manufacturers RSA double compression Cable Gland as per the requirement of **BS 6121-1:2005; & IEC/EN 62444 (Harmonized std. for European low voltage directive 2014/35/EU)**.

Technical Data:

Design specification	: IEC 62444
Electrical Category	: Category B
Mechanical Category	: Impact Category 8 (IK 10),
Level of ingress protection	: IP66 (EN 60529)
Cable type	: Armoured (SWA - AWA)
Seal Operating temperature	: Neoprene -from -20°C to +130 °C Silicon -from -20°C to +200°C (Optional)
Material	: Brass, Stainless steel, Nickel plated brass, Aluminum
Thread Type	: Metric/NPT (Other thread types also available upon request: PG/ANS)

Exploded View Of RSA Cable gland:

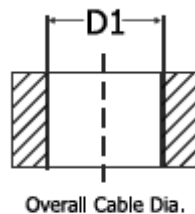

(B)

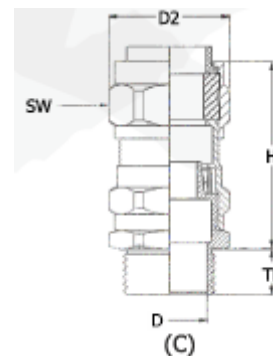

(C)

Item	Item Description
1	Entry nut.
2	Retainer ring blue
3	Compression washer
4	Main body
5	Sealing ring
6	Armour
7	Cone body
8	Cable

Product Code Table:

No. of Sealing	Size	Material				Sealing material		Code
		BR	NI	SS	Al	SI	N	
Single	Metric: MXXXX	Brass	Nickel Plated Brass	Stainless Steel	Aluminum	Silicon	Neoprene	RSAM20SBRN

Thread Type	RSA Cable gland code	Clamping Range (mm) Ø min-max (Dig.--b)	Cable gland dimension				
			D1 (mm)	H (mm)	TL (mm)	SW (mm)	D (mm)
M20x1.5	RSAM20S	6.1-13	42.5	10	24	26.5	26.5
M20x1.5	RSAM20M	9.5-15.8	42.5	10	24	26.5	26.5
M20x1.5	RSAM20L	12.5-20	42.5	10	30	33	33
M25x1.5	RSAM25S	14-21.9	52	10	38	41.5	41.5
M25x1.5	RSAM25L	18.3-25.2	56	10	38	41.5	41.5
M32x1.5	RSAM32L	23.8-33	56	10	46	50.5	50.5
M40x1.5	RSAM40L	28.0-40	58.5	15	55	60	60
M50x1.5	RSAM50S	35.2-46	58.5	15	60	66	66
M50x1.5	RSAM50L	40.5-52.5	60	15	70	75	70
M63x1.5	RSAM63S	45.7-59	65	15	75	82	82
M63x1.5	RSAM63L	54.7-65	65	15	80	86	86
M75x1.5	RSAM75S	59-71.5	73	15	90	98	98
M75x1.5	RSAM75L	66.8-78	78	15	98	106	106
M90x1.5	RSAM90L	76.2-90	98	24	114	125	125
M100x1.5	RSAM100L	76-90	140	24	123	135	135