

EURO SERIES CABLE GLANDS



Raychem RPG Manufacturers Cable Gland as per the requirement of IEC/EN 62444.

A device designed to permit the entry of a cable, flexible cable or insulated conductor into an enclosure, and which provides sealing and retention. It also provides significant functions such as insulation, cable guarding, strain relief or a combination of these. They are mechanical fittings that form part of the electrical installation material.

The PA 66 sealing inserts are long-term stable and do not outgas. This is why this cable gland is also suitable for applications outdoors and in the chemical industry. The sealing inserts consist of PA 66 and EPDM, the gland bodies of Brass, Brass Nickel Plated & Stainless steel. The glands comply with RoHS (which means free of heavy metals) and thus meet current EU requirements.

Benefits: -

- Highly reliable.
- High quality strain relief and sealing.
- Good performance for standard industrial application.
- Easy assembly: install cable gland – insert cable – tighten cap.

Application: -

- For metal machines and housing.
- For standard industrial applications in harsh environments.
- Machine and equipment manufacturing.
- Chemical industries.

Technical data: -

Material	Brass, Brass Nickel Plating, Stainless steel
Sealing	EPDM
Clamping insert	PA 66
O ring	EPDM
Seal operating Temperature	-40°C to +100°C
Thread type	Metric (M) ISO Pitch 1.5 (Also available with long thread length)
Degree of protection	IP 68 (5 bar 30 min)
Mechanical strength	High strain relief
Application area	Industrial, chemical industries, petrochemical industries

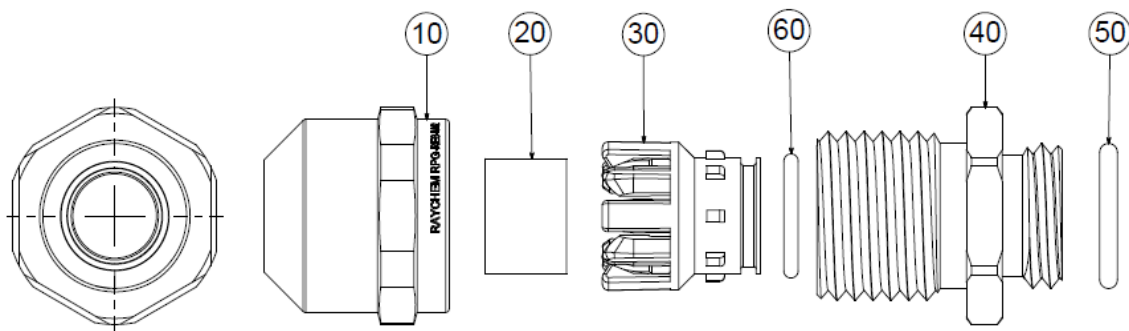

POS NO.	DESCRIPTION	MATERIAL
10	ENTRY NUT	BRASS / SS316L
20	SEALING RUBBER	EPDM
30	PLASTIC INSERT	POLYAMIDE 66
40	CONE BODY	BRASS / SS316L
50	'O' RING	EPDM
60	'O' RING	EPDM

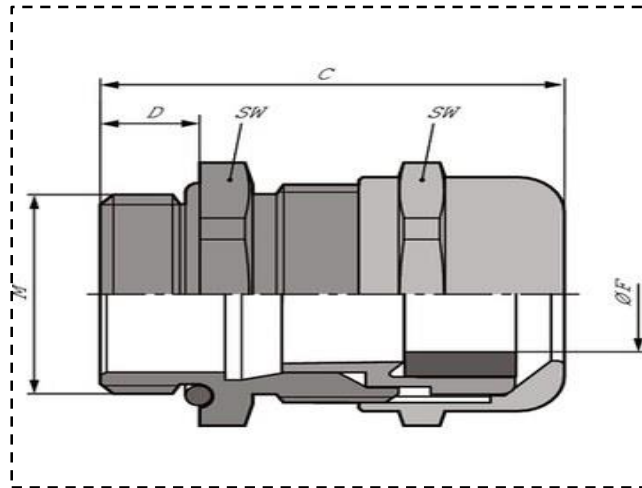

Table: 1 Metric/short thread

Part code	Size M	Clamping Range ØF (mm)	SW (mm)	C (mm)	D (mm)
RESM-12	M 12 x 1,5	3.0 – 7.0	16	23 – 30	5
RESM-16	M 16 x 1,5	4.5 – 10.0	20	26 – 34	5
RESM-20	M 20 x 1,5	6.0 – 13.0	24	29 – 37	6
RESM-25	M 25 x 1,5	9.0 – 16.0	29	33 – 42	7
RESM-32	M 32 x 1,5	13.0 – 21.0	36	36 – 44	8
RESM-40	M 40 x 1,5	16.0 – 28.0	46	44 – 55	8
RESM-50	M 50 x 1,5	21.0 – 35.0	55	51 – 62	9
RESM-63	M 63 x 1,5	34.0 – 48.0	68	56 – 67	10
RESM-75	M 75 x 1,5	48.0 – 62.0	82	67 – 81	12